

For Further Information Contact

Heason Technologies Group Ltd

Tel: +44(0)1403 755800

Fax: +44(0)1403 755810

Email: sales@heason.com

Freephone 0800 374903 www.heason.com

Heason
Technologies Group

DANAHER
MOTION

LM-600™ Crossed Roller Way Table



Product Dimensions

Dimensions - Top View

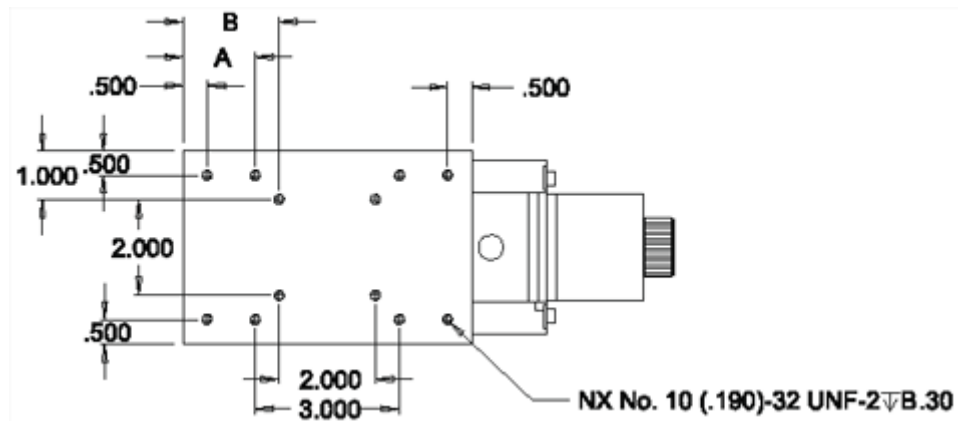

Dimensions - Side View

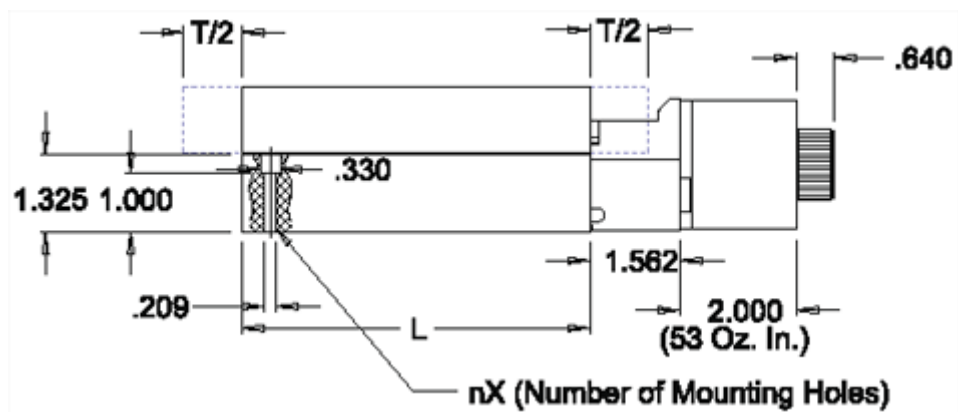

For Further Information Contact

Heason Technologies Group Ltd

Tel: +44(0)1403 755800

Fax: +44(0)1403 755810

Email: sales@heason.com

Freephone 0800 374903 www.heason.com

Heason
Technologies Group

DANAHER
MOTION

LM-600™ Crossed Roller Way Table

Dimensions - Bottom View

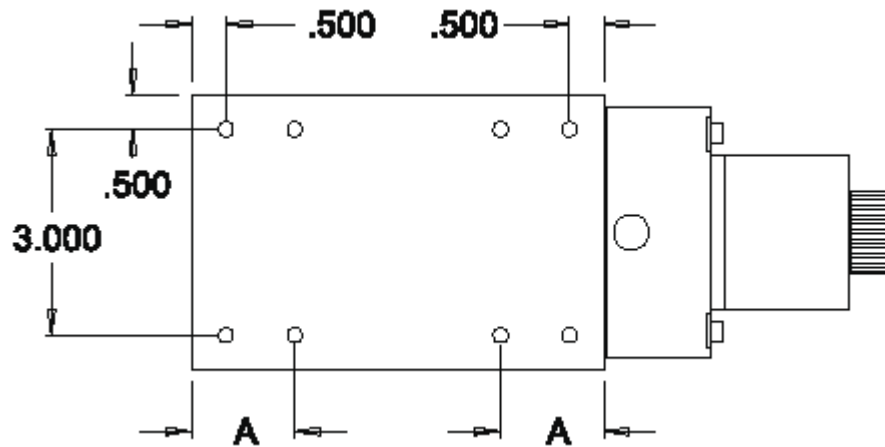

Dimensions - End View

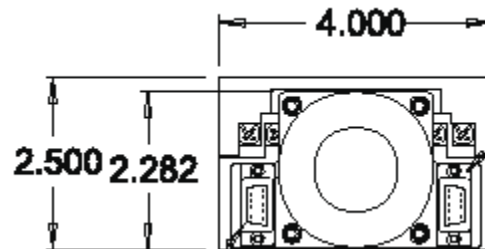

LM-600™ Crossed Roller Way Table

Specifications

Travel (inches)		6
Leadscrew Accuracy (μm)	Precision	20
	Commercial	75
Bidirectional Repeatability (μm)	Precision	3
	Commercial	6
Flatness & Straightness (μm)	Precision	8
Pitch & Yaw (arc-seconds)		25
Load Capacity (kg) ¹		125
Maximum Leadscrew Speed (rps)		15
Mass (kg)	Moving	0.9
	Total	3.9

Configurations ²

Leadscrew	Lead (inch)	Precision Commercial	0.40, 0.20, 0.10, 0.02 0.50, 0.40, 0.20, 0.10, 0.02
	Lead (mm)	Precision Commercial	2 3, 2, 1.4
Motor	Stepper (oz-in)	400 step/rev 200 step/rev	118, others available 53, 100, others available
	Servo ³		brush, brushless

Options

Encoder	Rotary (counts/rev.)	2000, 4000
	Linear (counts/rev.) ³	5, 1, 0.5, 0.1

¹ Please contact our Applications Engineers for loads exceeding 35kg.

² Standard configuration is highlighted.

³ No servo with linear encoder.